

Wheel Spacer/Compatible Skid

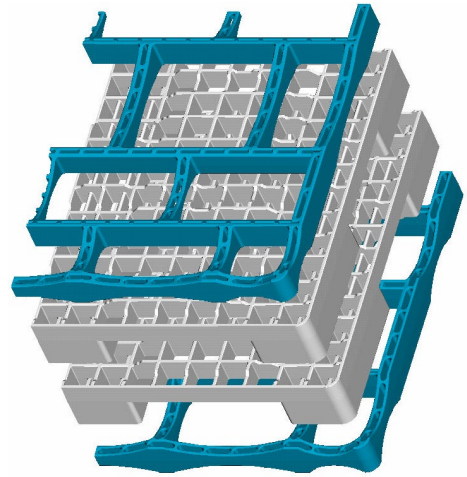
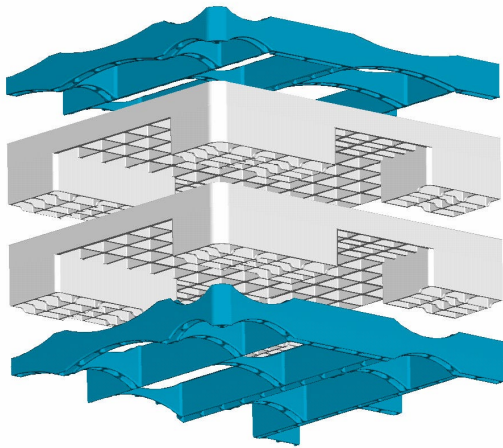

- Single unit polymer construction, eliminating wood dust/debris contamination.
- Open checkerboard configuration with no closed areas eliminating fluid and debris collection.
- Robust and durable design and construction weighing 49.9 lbs. (22.4 Kg.) with heavy-duty capacity (30,000 lbs. static; 5,000 lbs. dynamic).
- Nestable on itself.
- Seats both spacer models on top deck and bottom of feet minimizing spacer slippage.
- Four-way fork truck entry.
- Two-way pallet jack entry (four-way pallet jack entry using four-way pallet jacks or standard jack with at least 14 inches between forks).
- General-purpose platform.
- Bottom of feet designed for easy movement over manual roller conveyor systems.
- Capable of withstanding high temperature loads (230 degrees F+).
- Glass fiber reinforced for added strength and high temperature resistance.
- Recyclable